

2024 INSPIRE CUP

Hosted By Inspire Sports In Beautiful Victoria, British Columbia



V6.0



Sponsor: Inspire Sports Victoria

Dates: March 1st - 3rd

Location: Victoria Conference Centre

Address: 720 Douglas St,
Victoria, BC



Welcome to the Inspire Cup!

We believe sports is a universal language that brings people together. This years Inspire Cup will serve as the first of many for this annual competition hosted in beautiful Victoria, the garden city, with tourism, shopping, and family activities for all!

Inspire Cup Contact Information

Contacts: Lucas and June Tiefenbach
(P): (250) 590-5950 (leave messages in mailbox)
(E): iscup@inspiresportsvictoria.com

Website and Social Media

[Instagram: @theinspirecup](https://www.instagram.com/theinspirecup)
www.inspiresportsvictoria.com



Event Information

Date

March 1st - 3rd, 2024

Levels Offered

MAG:
Interclub, P1, P2, P3, P4, P5, Aspire, National Open, Junior, Senior
WAG:
Interclub, Xcel, CCP 1, 2, 3, 4, 5, 6, 7, 8, 9, 10,

Registration Information and Fees

Registration will be done via Kscore for Individual athletes and will cover the cost of admission for the athlete as well as costs associated with judges, set-up, and officiating.

Register online through Kscore will open September 15th 2023. Early Bird Registration will take place September 15th 2023 through to December 1st 2023. Regular registration will be from December 2nd until one week before the event.

Registration Fee: \$140

Late Fee: \$150

Scratch Deadline: One week before event.

Cut off Dates and Refunds

ALL withdrawals after above deadline will be subject to a \$20.00 admin fee provided that a medical note and a completed scratch email is sent 48 hours prior to competition

| | | | | |
|-----------|---|------------|-----------------|-------------------------|
| Music | <p>Music will be available via AUX plug in . Please bring your music on a digital device that can be plugged in. We will also try to have CD available as well. ** Please help keep this event as organized as possible by meeting all set out deadlines.</p> | | | |
| Admission | There will be a general admission fee for Day Passes.☐ | Kids (0-5) | Children (6-12) | Regular Admission (13+) |
| | | FREE | \$10 | \$15 |

VENUE INFORMATION

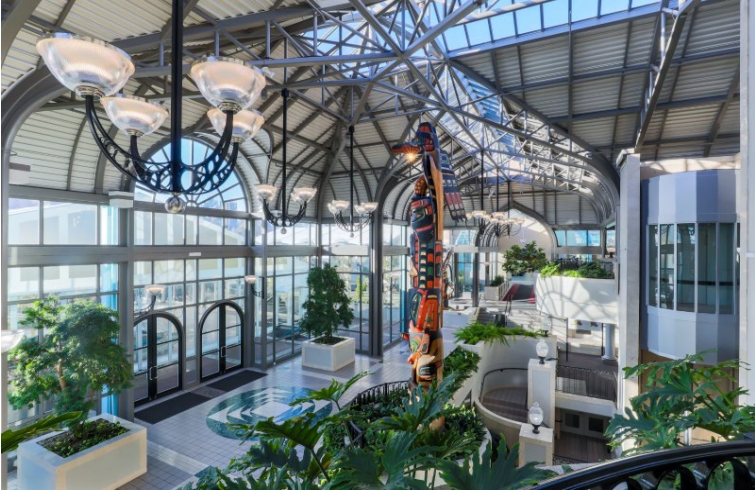

Victoria Conference Centre The Conference Centre is located adjacent to the beautiful and world renowned Inner Harbour of Victoria BC connected to the 5 star Fairmont Empress hotel.

Parking

Parking will be available at the Victoria Conference Centre (VCC). The VCC has a two-level, 305-vehicle underground parking garage with access from Douglas Street.

The parkade is open daily (year-round) from 5:00 a.m. until midnight with an attendant on duty. After hours, the parkade is secured. Rates are \$2/30 minutes up to a daily maximum of \$20. There is a height restriction of 6'2" (1.88 m).

Recommendations: All Hotels are walking distance (less than 300 meters). Park car at hotel and walk to venue.

Equipment

FIG Spieth America provided by Gymnastics BC



Below are the options for booking accommodations and their group codes

| Hotel | Book By | Reservation Method |
|--------------------|----------|---|
| Chateau Victoria | Jan 29th | The block Code is: 2024inspire ; Last day to book; |
| Delta Hotels | Jan 16th | https://www.marriott.com/events/start.mi?id=1699993458493&key=GRP Last day to book is 16th of January |
| The Parkside Hotel | Jan 31st | https://be.synxis.com/?adult=1&arrive=2024-03-01&chain=27580&child=0&config=YYJPA&currency=CAD&depart=2024-03- |

| | | | |
|-----------------------|---|----------|---|
| | Marriott Hotel Inner Harbour | Jan 30th | https://www.marriott.com/event-reservations/reservation-link.mi?id=1700253688721&key=GRP&app=resvlink |
| | Double Tree by Hilton Hotel | Jan 31st | https://www.hilton.com/en/book/reservation/deeplink/?ctyhocn=YYJSDT&groupCode=CDTISC&arrivaldate=2024-03-01&departuredate=2024-03-03&cid=OM,WW,HILTONLINK,EN,DirectLink&fromId=HILTONLINKDIRECT |
| | Fairmont Empress Hotel | N/A | Officials and Operations Team |
| | Inn at Laurel Point | Jan 31st | https://reservations.travelclick.com/12209?groupID=4160896 |
| | Hotel Grand Pacific | Feb 1st | Booking code: MAR24INSPIRECUP |
| | The Venue is walking distance to plenty amazing hotels. A block booking is being arranged and will be on version 2 of the work plan to be released end of September. The second draft will list the hotels and the codes for reservations. | | |
| Transportation | BC Ferries and Public Transit (shown on Map above) | | |
| | Don't want to bring a car on the ferry? The ferry has a Connector bus that goes directly from the ferry and YYJ airport to the Inner Harbour. Save the money and park your vehicle on the Tswassen side and walk on. Public transit is also very easy as buses are roughly \$3.00 per person and stop directly at the Victoria Conference Centre. | | |
| Photography | Calieight Photography will be on-sight and offering photos for purchase. | | |

Inspire Cup FINAL Workplan March 1st - March 3rd

| Day | Session | Category | Warm-up | Comp Start |
|--------------------------|---------|---|----------------------------|----------------------------|
| Friday March 1st, 2024 | 1 | CCP 1, 2, 3 | 8:00 AM | 8:15 AM |
| | 2 | CCP 4, 5 | 11:15 AM | 11:30AM |
| | 3 | CCP 6 (2007-2012) | 1:45 PM | 2:00 PM |
| | 4 | CCP 6 (2013-2015) CCP 7 (2011-2015) | 5:15 PM | 5:30 PM |
| | Session | | Warm-up | Comp Start |
| Saturday March 2nd, 2024 | 5 | CCP 8 | 8:00 AM | 8:15 AM |
| | 6 | CCP 9 | 11:00 AM | 11:15 AM |
| | 7 | CCP 7 (2006-2010) MAG 3 & 4 & 5 | 2:30 PM WAG 2:15 PM MAG | 2:45 PM |
| | 8 | CCP 10, MAG Aspire, Open, TEAM | 6:00PM WAG MAG TBC | 6:15pm WAG MAG TBC |
| | Session | | Warm-up | Comp Start |
| Sunday March 3rd, 2024 | 9 | Xcel Bronze MAG 1 & 2 | 8:00 AM | 8:20 AM WAG 8:30 AM MAG |
| | 10 | Xcel Silver | 11:15 AM | 11:30 AM |
| | 11 | Xcel Gold (2006-2012) | 2:00 PM | 2:15 PM |
| | 12 | Xcel Gold (2013-2014) Xcel Platinum & Diamond Performance & Performance Plus | 5:00 PM | 5:15 PM |